

Električni verižni dviznik

Electric chain hoist



Električni verižni dviznik tip ECH

Electric chain hoist type ECH

Tip Type	A	B	C	D	K	Ø	F	J	P	L	Teža (kg) Weight (kg)
ECH 0,5	150	112	250	245	27	45	85	17	14	550	44
ECH 1	150	112	250	245	30	50	105	26	15	590	46
ECH 2	173	90	250	245	38	65	136	36	22	770	60

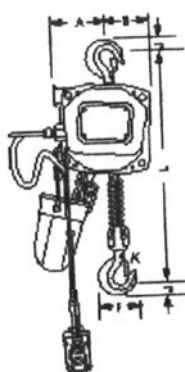

Tip	Nosilnost t	Veriga	Preizku. sila	Motor	Verig	Premer verig	Hitrost	Oznaka
Type	WLL t	Stand. Lift (m)	Proof load (kn)	Motor power (kw)	No. Of falls of load chain	Load chain diam. (mm)	Lift speed (m / min)	Art. No.
ECH 0,5	0,5	3	6,3	0,8	1	7,1	5,80	884301
ECH 1	1,0	3	12,5	1,1	1	7,1	4,30	884302
ECH 2	3	3	25	1,1	2	7,1	2,15	884303

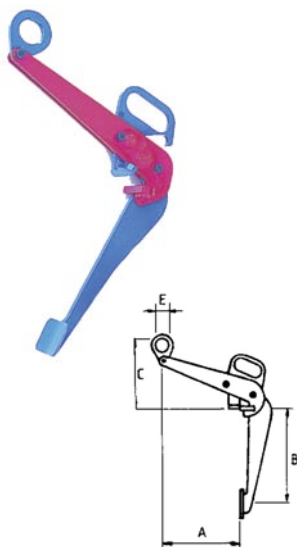
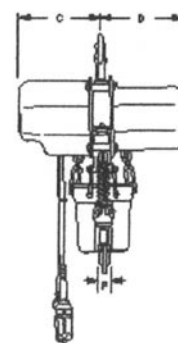

Prijemalo za sode tip IPDV

Tip	Premer sode	Način prijemanja	Nosilnost	Teža	Oznaka
Type	Barrel diameter (mm)	Grab type	Working load limit (kg)	Dead weight (kg)	Art. No.
GF 200	580 – 640	Stranska Side	200 kg	40	880037
GFO 200	580 – 640	Stranska Side	200 kg	50	880121
GF 500	580 – 640	Stranska Side	500 kg	50	880100
GFO 500	580 – 640	Stranska Side	500 kg	65	880122
GP 500	580 – 640	Stranska Side	500 kg	50	880083
FGR 500	580 – 640	Z vrha 4 oprijemi from top 4 grabs	500 kg	160	880084
IPDV 0,5	500 – 700	rob – en oprijem edge – one grab	500 kg	7	IP0118

Model prijemala GFO ima sistem za obračanje sode.

Clamps type GFO have barrel turning device.

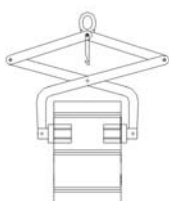

GP

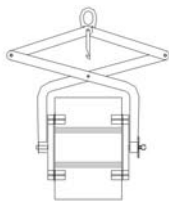

GF

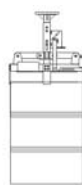

FGR

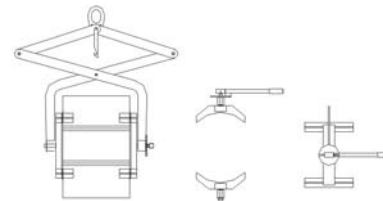

GFO

Prijemala Grabs

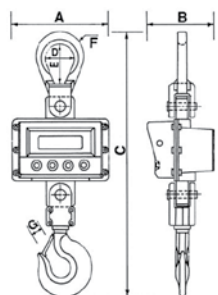

Digitalna tehtnica KPZ 402

Crane weigher KPZ 402

Tip Type	Nosilnost Capacity	Toleranca Tolerance	A	B	C	D	E	F	G	Teža Weight
402/003	300 kg	0,100 kg	265	185	480	70	80	16	22	8,0 kg
402/006	600 kg	0,200 kg	265	185	480	70	80	16	22	8,0 kg
402/015	1.500 kg	0,500 kg	265	185	570	75	90	25x30	26	13,4 kg
402/030	3.000 kg	1,0 kg	305	245	800	90	120	40x32	40	27,4 kg
402/050	5.000 kg	1,0 kg	305	245	825	90	120	40x32	40	28,0 kg
402/100	10.000 kg	10,0 kg	305	255	920	110	145	55x40	45	41,0 kg
402/200	20.000 kg	10,0 kg	270	360	1340	150	175	50x45	85	115,0 kg
402/300	30.000 kg	20,0 kg	270	360	1450	200	245	60x50	105	138,0 kg

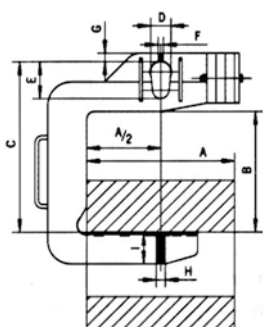

C kljuka za pločevino v kolutih tip CKP

C hook for coils type CKP

Dimenzije v mm

Dimension in mm

Tip Type	Nosilnost t* WLL t*	Teža kg** Wt kg**	A	B	C	D	E	F	G	H	I	Oznaka Art. No.
CKP 0.5	0.5	48	800	400	580	60	120	25	23	25	70	53507803
CKP 1.0	1.0	59	800	450	630	60	120	20	23	25	80	53507805
CKP 2.0	2.0	180	1000	500	750	75	150	20	35	40	125	53507810
CKP 3.0	3.0	215	1000	500	720	75	150	20	40	40	155	53507814
CKP 5.0	5.0	256	1000	550	820	100	200	30	45	50	180	53507817
CKP 10.0	10.0	772	1250	650	1000	130	250	45	55	70	240	53507824

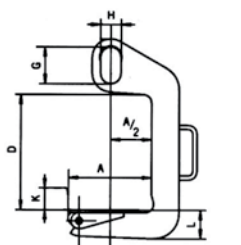

C kljuka za pločevino obračalna tip CKO

C hook for coils type CKO

Dimenzije v mm

Dimension in mm

Tip Type	Nosilnost t* WLL t*	Teža kg** Wt kg**	A min	A max	C	D	F	G	H	K	L	T	Oznaka Art. No.
CKO 1.0	1.0	12	100	200	60	460	20	110	60	60	65	20	881121
CKO 1.0	1.0	20	200	300	60	460	20	110	60	60	70	20	881231
CKO 2.0	2.0	25	100	200	60	420	30	135	75	80	85	25	882122
CKO 2.0	2.0	29	200	300	60	420	30	135	75	80	95	25	882232
CKO 3.0	3.0	45	100	200	80	610	40	160	90	90	100	35	883123
CKO 3.0	3.0	51	200	300	80	610	40	160	90	90	110	40	882233



Prijemala za pločevino

Clamp for plates

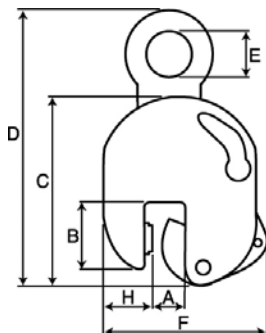

Prijemalo tip IP10 za pločevino (vertikalni transport)

Clamp type IP10 for steelplates (vertical transport)

Tip	Nosilnost t	Teža kg	A	B	C	D	E	F	G	H	J	K	Oznaka
Type	WLL t	Wt kg	Dimenzije v mm / Dimension in mm										Art. No.
0,5 - IP10	0,5	1,8	0-16	44	128	207	30	115	41	28	-	10	IP 1674
1 - IP10	1,0	2,0	0-20	45	139	215	30	126	41	38	-	10	IP 1662
2 - IP10	2,0	6,8	0-35	78	201	336	70	190	61	55	-	16	IP 1676
3 - IP10	3,0	13,8	0-40	100	253	436	75	225	78	60	-	20	IP 1664
4,5 - IP10	1,5	15,0	0-40	100	253	436	75	232	82	65	-	20	IP 1666
6 - IP10	6,0	23,5	0-50	126	302	515	80	292	84	95	40	20	IP 1668
9 - IP10	9,0	27,5	0-50	126	325	550	80	310	92	105	44	25	IP 1670
9 - IP10/J	9,0	28,5	50-100	126	325	555	80	360	92	105	44	25	IP 1672
12 - IP10	12,0	49,0	0-54	160	391	580	80	331	117	137	41	25	IP 1678
12 - IP10/J	12,0	58,0	54-108	178	439	630	80	415	117	137	41	25	IP 1680
16 - IP10	16,0	68,0	5-64	178	465	690	88	397	119	153	49	25	IP 1682
16 - IP10/J	16,0	90,0	64-128	208	521	746	88	472	119	151	49	25	IP 1684
22,5 - IP10	22,5	108,0	5-80	222	554	800	110	470	136	186	49	25	IP 1686
22,5 - IP10/J	22,5	110,0	80-155	253	628	880	110	575	136	196	49	25	IP 1688
30 - IP10	30,0	148,0	5-80	222	545	800	110	470	152	186	54	30	IP 1690
30 - IP10/J	30,0	152,0	80-155	250	620	880	110	565	152	196	54	30	IP 1692

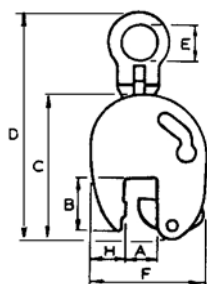

Prijemalo tip IPU10 za pločevino (vertikalni transport)

Clamp type IPU10 for steelplates (vertical transport)

Tip	Nosilnost t	Teža kg	A	B	C	E	F	G	H	J	K	Oznaka	
Type	WLL t	Wt kg	Dimenzije v mm / Dimension in mm										Art. No.
0,5 - IP10	0,5	1,9	0-16	44	128	30	115	41	28	-	10	IP 1675	
1 - IP10	1,0	2,1	0-20	45	139	30	126	41	38	-	10	IP 1663	
2 - IP10	2,0	7,6	0-35	78	201	70	190	61	55	-	16	IP 1677	
3 - IP10	3,0	14,8	0-40	100	253	75	225	78	60	-	20	IP 1665	
4,5 - IP10	1,5	16,0	0-40	100	253	75	232	82	65	-	20	IP 1667	
6 - IP10	6,0	24,0	0-50	126	302	80	292	84	95	44	20	IP 1669	
9 - IP10	9,0	29,5	0-50	126	325	80	310	92	105	44	20	IP 1671	
9 - IP10/J	9,0	30,5	50-100	126	325	80	360	92	105	44	20	IP 1673	
12 - IP10	12,0	57,0	0-54	160	391	80	331	117	137	41	25	IP 1679	
12 - IP10/J	12,0	59,0	54-108	178	439	80	415	117	137	41	25	IP 1681	
16 - IP10	16,0	72,0	54-64	178	465	88	397	119	153	45	25	IP 1683	
16 - IP10/J	16,0	85,0	64-128	208	521	88	472	119	161	45	25	IP 1685	
22,5 - IP10	22,5	127,0	5-80	222	554	110	470	136	186	49	25	IP 1687	
22,5 - IP10/J	22,5	130,0	80-155	253	628	110	575	136	196	49	25	IP 1689	
30 - IP10	30,0	153,0	5-80	222	545	110	470	152	186	54	30	IP 1691	
30 - IP10/J	30,0	165,0	80-155	250	620	110	565	152	196	54	30	IP 1693	



Prijemalo tip IPU10/H Za trdo pločevino pločevino (do 47 HRC)

Clamp type IP10U/H for hard steel plates (till 47 HRC)

Tip	Nosilnost t	Teža kg	A	B	C	D	E	F	G	H	J	K	Oznaka
Type	WLL t	Wt kg	Dimenzije v mm / Dimension in mm										Art. No.
0,5 IPU10/H	0,5	1,8	0-16	44	128	228	30	115	41	28	-	10	IP 2175
1 IPU10/H	1	7,6	0-35	78	201	372	70	190	61	55	-	16	IP 2177
2 IPU10/H	2	14,8	0-40	100	253	445	75	225	78	60	-	20	IP 2165
3 IPU10/H	3	16,0	0-40	100	253	445	75	232	82	65	-	20	IP 2167
4,5 IPU10/H	4,5	24	0-50	126	302	525	80	292	84	95	-	20	IP 2169

Prijemala za pločevino

Clamp for plates

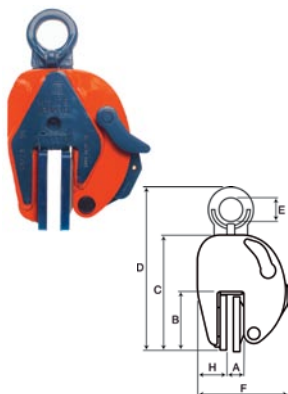

Prijemalo tip IPNM

polirano za pločevino (vertikalni transport)

Clamp type IPNM

for steelplates (vertical transport)

Tip	Nosilnost t	Teža kg	A	B	C	D	E	F	G	H	K	Oznaka
Type	WLL t	Wt kg	Dimenzije v mm / Dimension in mm									Art. No.
0,5 - IPNM	0,5	2,5	0-10	74	149	205	30	128	60	38		IP 3276
1 - IPNM	1,0	4,1	0-20	85	187	258	30	170	80	50		IP 3277
1 - IPNM	1,0	5,3	30-37	92	215	289	30	265	95	85		IP 3312



Prijemalo tip IPHOZ

za pločevino (horizontalni transport)

Clamp type IPHOZ

for steelplates (horizontal transport)

Tip	Nosilnost t	Teža kg	A	B	C	E	F	G	H	J	K	Oznaka
Type	WLL t	Wt kg	Dimenzije v mm / Dimension in mm									Art. No.
0,75-IPHOZ	0,75	6,0	0-30	94	16	16	70	118	81	12	12	IP 5401
1,5-IPHOZ	1,5	11,0	0-45	133	16	22	125	192	110	16	12	IP 5402
3-IPHOZ	3,0	16,0	0-45	137	20	26	125	200	120	20	10	IP 5403
4,5-IPHOZ	4,5	17,0	0-45	138	25	30	126	220	120	20	10	IP 5404
6-IPHOZ	6,0	31,0	0-60	171	30	36	135	235	130	20	20	IP 5405
9-IPHOZ	9,0	41,0	0-60	211	30	43	166	276	160	25	20	IP 5406
12-IPHOZ	12,0	76,0	0-60	217	40	47	168	294	190	25	19	IP 5407
15-IPHOZ	15,0	76,0	0-60	220	40	47	183	317	250	25	22	IP 5408

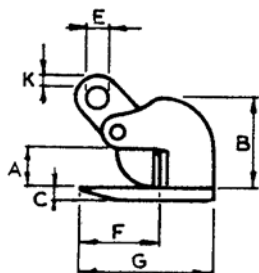

Prijemalo tip IPHTONZ

za pločevino (horizontalni prevoz)

Clamp type IPHTONZ

for steelplates (horizontal transport)

Tip	Nosilnost t	Teža kg	A	B	C	E	F	G	H	J	K	Oznaka
Type	WLL t	Wt kg	Dimenzije v mm / Dimension in mm									Art. No.
0,75-IPHTONZ	0,75	4,0	0-30	75	16	16	64	118	81	12	46	IP 5343
1,5-IPHTONZ	1,5	9,0	0-60	114	16	22	98	153	110	16	52	IP 5344
3-IPHTONZ	3,0	14,0	0-60	117	20	26	98	163	120	20	69	IP 5477
4,5-IPHTONZ	4,5	20,0	0-60	132	25	30	99	183	130	20	69	IP 5483
6-IPHTONZ	6,0	25,0	0-60	143	25	36	108	213	130	20	69	IP 5484
9-IPHTONZ	9,0	31,0	0-60	157	30	43	118	223	140	25	86	IP 5485
12-IPHTONZ	12,0	41,0	0-60	172	30	47	134	254	150	25	88	IP 5486
15-IPHTONZ	15,0	54,0	0-60	183	30	47	144	284	200	25	88	IP 5487
25-IPHTONZ	25,0	78,0	0-60	169	40	47	170	300	220	32	113	IP 5119
3-IPHSZ	3,0	22,0	0-100	192	20	26	160	222	140	20	65	IP 5308
6-IPHSZ	6,0	36,4	0-100	200	25	32	160	249	180	20	69	IP 5311
9-IPHSZ	9,0	49,2	0-100	220	30	35	170	270	190	25	85	IP 5313
12-IPHSZ	12,0	62,8	0-100	220	35	47	170	270	200	25	95	IP 5318

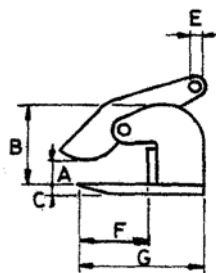

Prijemala Clamps

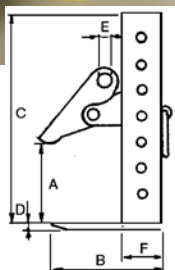

**Prijemalo tip IPPE
za pločevino v paketih**

**Clamp type IPPE
for steelplates in packages**

Tip	Nosilnost t	Teža kg	A	B	C	D	E	F	G	H	J	Oznaka
Type	WLL t	Wt kg	Dimenzije v mm / Dimension in mm									Art. No.
3 - IPPE	3,0	21,0	0-180	194	256	20	26	66	20	140	76	IP 0501
3 - IPPE	3,0	26,0	0-300	194	376	20	26	66	20	140	76	IP 0502
3 - IPPE	3,0	28,0	0-420	194	496	20	26	66	20	140	76	IP 0503
6 - IPPE	6,0	46,0	0-420	227	516	25	30	102	20	160	76	IP 0506
9 - IPPE	9,0	62,0	0-420	270	566	25	34	122	20	190	76	IP 0509
12 - IPPE	12,0	104,0	0-420	292	588	30	40	133	25	200	97	IP 0512

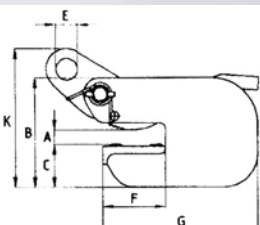

**Prijemalo tip IPBC
za pločevino (horizontalni transport)**

**Clamp type IPBC
for steelplates (horizontal transport)**

Tip	Nosilnost t	Teža kg	A	B	C	E	F	G	H	J	K	Oznaka
Type	WLL t	Wt kg	Dimenzije v mm / Dimension in mm									Art. No.
1 - IPBC	1,0	3,5	0-20	132	52	26	75	135	36	16	182	IP 0410
2 - IPBC	2,0	6,5	0-25	152	62	30	82	152	49	20	218	IP 0411
3 - IPBC	3,0	8,5	0-25	157	66	30	82	210	57	20	225	IP 0412

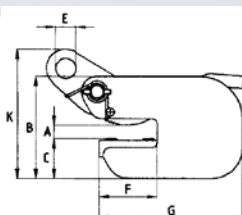

**Prijemalo tip IPBHZ
za profile**

**Clamp type IPBHZ
for profiles**

Tip	Nosilnost t	Teža kg	A	B	C	D	E	F	G	J	K	Oznaka
Type	WLL t	Wt kg	Dimenzije v mm / Dimension in mm									Art. No.
0,75 - IPBHZ	0,75	3,0	0-25	40	148	220	50	130	69	33	22	IP 5461
1,5 - IPBHZ	1,5	6,0	0-25	60	200	255	50	153	73	35	28	IP 5462
3 - IPBHZ	3,0	10,5	0-40	80	227	325	70	188	112	38	32	IP 5463
4,5 - IPBHZ	4,5	25,0	0-40	112	284	413	70	251	116	80	40	IP 5464

Prijemala Clamps

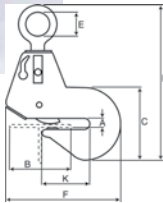
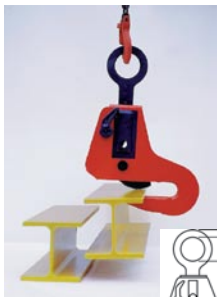

**Prijemalo tip IPBSNZ
za profile**

**Clamp type IPBSNZ
for profiles**

Tip	Nosilnost t	Teža kg	A	B	C	D	E	F	G	H	J	Oznaka
Type	WLL t	Wt kg	Dimenzije v mm / Dimension in mm									Art. No.
1,5 – IPBSNZ	1,5	14,0	0-32	100-270	304	480	70	319	47	16	165	IP 5925
3 – IPBSNZ	3,0	22,5	0-40	100-330	352	494	75	408	56	20	207	IP 5926
4,5 – IPBSNZ	4,5	30,5	0-50	100-360	420	630	75	457	56	20	250	IP 5927

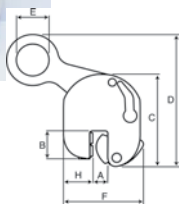

**Prijemalo tip IPBKZ
za profile**

**Clamp type IPBKZ
for profiles**

Tip	Nosilnost t	Teža kg	A	B	C	D	E	F	G	H	J	Oznaka
Type	WLL t	Wt kg	Dimenzije v mm / Dimension in mm									Art. No.
0,75 – IPBKZ	0,75	3,0	5-15	43	132	192	45	113	47	38	10	IP 5780
1,5 – IPBKZ	1,5	7,0	5-25	62	210	300	70	163	61	50	16	IP 5781
3,75 – IPBKZ	3,75	15,5	5-28	75	260	415	100	202	78	52	20	IP 5782

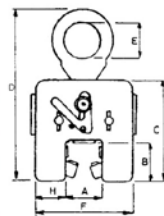

Prijemalo za tračnice tip IPRLN

Clamp for rails type IPRLN

Tip	Nosilnost t	Teža kg	A	B	C	D	E	F	G	J	K	Oznaka
Type	WLL t	Wt kg	Dimenzije v mm / Dimension in mm									Art. No.
2- IPRLN	2,0	15,0	?	90	222	375	75	230	102	74	20	IP 0963

Magnetno prijemalo tip ML

Magnetic lifter type ML

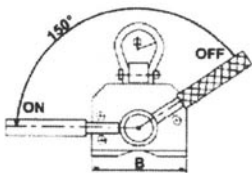

Tip	Nosilnost t	Teža kg	B	H	H1	L1	L	R	Ø	Oznaka
Type	WLL t	Wt kg	Dimenzije v mm / Dimension in mm							Art. No.
ML300	300	7	90	190	98	185	210	230	50	883001
ML500	500	17	100	210	118	243	270	220	50	883002
ML1000	1000	38	142	291	148	338	375	318	60	883003
ML2000	2000	95	184	362	182	470	85	515	420	883004
ML3000	3000	150	240	420	220	540	581	520	80	883005
ML5000	5000	220	360	500	250	650	692	720	100	883006

